

Xiaomi UniBlade Trimmer
User Manual

Read this manual carefully before use, and retain it for future reference.

Safety Instructions
Warnings

- This appliance can be used by children aged from 8 years and above and persons with reduced physical, sensory or mental capabilities or lack of experience and knowledge if they have been given supervision or instruction concerning use of the appliance in a safe way and understand the hazards involved.
- Children should be supervised to ensure that they do not play with the appliance.
- Cleaning and user maintenance shall not be made by children without supervision.
- Please keep the trimmer out of reach of children. Do not let children play with it.
- This trimmer is only to be used with the power supply unit supplied with it.
- The handheld part can be cleaned with water only after being disconnected from the charging cable. When cleaning the handheld part, cover the charging port first and keep it dry.
- When the charging cable is damaged, it must be replaced with an original one purchased from the manufacturer or the after-sales service team.
- Do not use damaged trimmer head and trimming comb. Before use, please check whether the trimmer is damaged and whether the sound is normal.
- Before turning off the trimmer, please make sure



01

- the trimmer head is away from the human body.
- Do not charge the trimmer in humid environments.
- Do not disassemble the trimmer to replace the battery. This appliance contains battery that is non-replaceable.
- Do not directly pull the cable of charging dock when plugging in and unplugging the charging plug.
- This appliance contains built-in lithium-ion battery. Do not disassemble, impact, crush the battery or throw it into fire. If there is severe swelling, do not continue to use. Do not leave the battery in high temperature environment.
- Do not place or insert any foreign objects into this trimmer.
- Do not modify or repair this trimmer yourself.
- This trimmer is not suitable for use in the bathtub or shower.
- The trimmer head may become hot after prolonged use.
- This trimmer is only for trimming beard and body hair. Do not use it for other purposes.
- If you come into physical contact with any substance that may leak out of the battery, please rinse the contact area with plenty of water and seek medical attention immediately.
- This appliance contains battery that is only replaceable by skilled persons.

02



This indicates that the trimmer can be rinsed under running water.



Read operator's manual.

Cautions

- Before charging, please make sure the trimmer and its charging port are dry.
- When charging, make sure to use an charger of 5 V=1 A.
- Fully charge the trimmer at least once every six months, if it has not been used for an extended period of time.

Notes:

- This trimmer is intended for indoor use only.
- This trimmer is intended for use by a single individual only.
- When traveling, make sure the bottom cover is closed and the travel lock is enabled to protect the trimmer.
- Only charge, use, and store the trimmer at a temperature between 5°C and 35°C.
- Do not wrap the cable of the charging dock around the trimmer to avoid damage to the cable.
- The body of this trimmer meets the IPX7 standard for waterproofing and can be cleaned with water. However, it should not be immersed in water for an extended period of time.

03

Product Overview

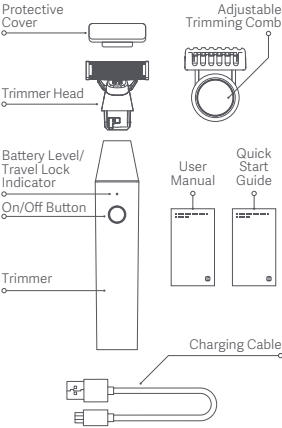

Note:
• Illustrations of product, accessories, and user interface in the user manual are for reference purposes only. Actual product and functions may vary due to product enhancements.

04

How to Use

Notes:

- Prior to the first use, it is recommended to fully charge the trimmer and clean the trimmer head.
- It is normal that the skin is slightly irritated during the first few times you shave. It is recommended that the trimmer is used regularly (at least three times per week) over a three-week period so that your skin can adapt to it.
- Improper use of the product may easily damage the trimmer head. Please check the product's condition prior to use. If it is damaged, please stop using it.
- The trimmer supports both wet and dry use. For the more challenging areas, such as the jaw and neck, it is recommended to shave against the direction of hair growth.

Charging

Connect the supplied charging cable and an appropriate power adapter (purchased separately) and turn on the power.

Turning on/off

Press the on/off button.

Trimming comb adjustment

Attach the adjustable trimming comb to the trimmer head and turn the knob to the desired length.

Shaving

Apply gentle, constant pressure while moving the trimmer slowly over the skin for shaving and grooming.

05

Battery level indicator description:

Trimmer status	Indicator status	Battery level
Charging	Blinking orange	0~20%
	Blinking white	20~100%
	Keeping white	100%
Working	Keeping white	20~100%
	Blinking orange	10~20%
	Blinking orange rapidly for three times (Unable to turn on)	Less than 10%

Notes:

- When the trimmer cannot be turned on due to low battery, it will take about 1.5 hours to fully charge it.
- The trimmer can be used for about 60 minutes on a full charge.
- When the battery power is low, please charge in time, as the trimmer cannot be used while charging.
- Fully charge the trimmer at least once every six months, if it has not been used for an extended period of time.

06

Travel lock

- Enabling the travel lock: When the trimmer is turned off, press and hold the on/off button for about 2.5 seconds. Then the motor will no longer rotate and the travel lock will be enabled. The indicator will blink three times and the trimmer will vibrate once.
- Disabling the travel lock: Press and hold the on/off button for about 2.5 seconds. Then the indicator will blink three times and the trimmer will be turned on. The travel lock will be disabled.

Note: When the travel lock is enabled, in the event of pressing the on/off button, the indicator will blink but the motor will not start, thus preventing the trimmer from being turned on accidentally.

Care & Maintenance

To maintain optimal performance of the trimmer, clean it after each use.

1. When cleaning the trimmer, make sure it is turned off and not charging.
2. Remove the adjustable trimming comb, and clean the hair from it and the trimmer head.



3. Rinse the trimmer, trimmer head and adjustable trimming comb with water.
4. Allow all components to dry before reassembling, charging and using.

Note:

- It is recommended to replace the trimmer head every six months to ensure good performance of the trimmer.

07

Environmental Protection

When the trimmer reaches the end of its service life, the built-in battery must be removed and properly disposed of in accordance with the laws and regulations of the country or region where it is located. If the battery cannot be removed, it is recommended to dispose of the trimmer in strict accordance with the local regulations on the classification and management of household waste.

WARNINGS:

- The trimmer contains a non-replaceable battery.
- Do not expose the battery to fire to prevent it from exploding or releasing toxic and hazardous substances.
- Do not short-circuit the battery to prevent it from igniting and causing a fire.
- When removing the battery, make sure the trimmer has been disconnected from power and the battery has been depleted.
- The battery must be removed from the appliance before it is scrapped.
- The appliance must be disconnected from the supply mains when removing the battery.
- The battery is to be disposed of safely.
- When the battery is at end of life, the appliance shall be properly disposed of.

Instructions for battery removal

1. Open the bottom cover. Use a small flat head screwdriver to pry open the inner cover of the trimmer (It cannot be recovered after disassembly).

08

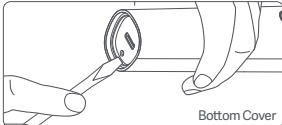

Bottom Cover

2. Use a Phillips head type screwdriver to remove the screws on the bottom and hold the upper part of the inner compartment to pull it out from the bottom.

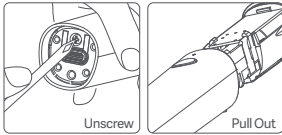

Unscrew

Pull Out

3. Use a flat head screwdriver to pry open the clips on both sides of the battery cover. Use scissors to cut the wires connecting the battery to the motherboard, and be careful to avoid short-circuiting the battery cables. Remove the battery and dispose of it properly.

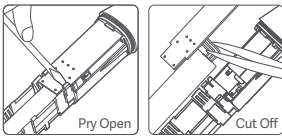

Pry Open

Cut Off

09

Troubleshooting

Issues	Possible Causes	Solutions
Poor-quality shaving	Trimmer head is damaged or worn out.	Replace the trimmer head.
	Trimmer is clogged with stubbles.	Clean thoroughly.
Trimmer not working after pressing the on/off button	Travel lock is enabled.	Press and hold the on/off button for about 2.5 seconds to unlock.
	Battery is depleted.	Charge the battery in a timely manner.
	On/off button does not function.	Contact the after-sales service team.
Irritated skin after shaving	Skin is yet to adapt to the trimmer.	Skin irritation will fade after 2~3 weeks of use.
	Charging contact is poor.	Reposition the charging contact.
Charging errors	Power adapter is damaged.	Replace the power adapter.
	Charging ambient temperature is too low or too high.	Charge in an ambient temperature between 5°C and 35°C.
	Trimmer is damaged.	Contact the after-sales service team.

10

Less than 60 minutes usage time after being fully charged	Load on the motor is increased because the trimmer head hasn't been cleaned for a long time.	Clean thoroughly.
	It is affected by shaving style and beard density.	It is normal.

Specifications

Name: Xiaomi UniBlade Trimmer
Model: X300
Operating Voltage/Power: 3.7 V = /3 W
Input: 5 V =1 A
IP Rating: IPX7
Charging Time: Approx.1.5 h
Maximum H-field Strength: 13.90 dBµA/m at 3 m
Electric Field Strength: 0.643 V/m at 10 cm

11

WEEE Disposal and Recycling Information

All products bearing this symbol are waste electrical and electronic equipment (WEEE as in directive 2012/19/EU) which should not be mixed with unsorted household waste. Instead, you should protect human health and the environment by handing over your waste equipment to a designated collection point for the recycling of waste electrical and electronic equipment, appointed by the government or local authorities. Correct disposal and recycling will help prevent potential negative consequences to the environment and human health. Please contact the installer or local authorities for more information about the location as well as terms and conditions of such collection points.



Manufactured by: Shenzhen Soocas Technology Co., Ltd., Room 401, 402, 1101, 1102, 1103, 1104, Building 2 Chongwen Area, Nanshan iPark, No. 3370 Liuxian Avenue, Fuguang Community, Taoyuan Subdistrict, Nanshan District, 518000, Shenzhen, China
Imported by: Xiaomi Technology India Pvt. Ltd., Orchid (Block E), Embassy Tech Village, Devarabeesanahalli, Marathahalli-Sarjapur Outer Ring Road, Bangalore - 560103, Karnataka
For Consumer Complaints Contact:
Manager, Customer Care, Xiaomi Technology India Pvt. Ltd., Ground Floor, AKR Infinity, Sy. No.113, Krishna Reddy Industrial Area, 7th Mile, Hosur Road, Bangalore - 560068, Karnataka, Phone No.1800 1036286,
Email: service.in@xiaomi.com
For further information, please go to www.mi.com
User Manual Version: V1.0

13