

Redmi Buds 5

Product overview

Read this manual carefully before use, and retain it for future reference.

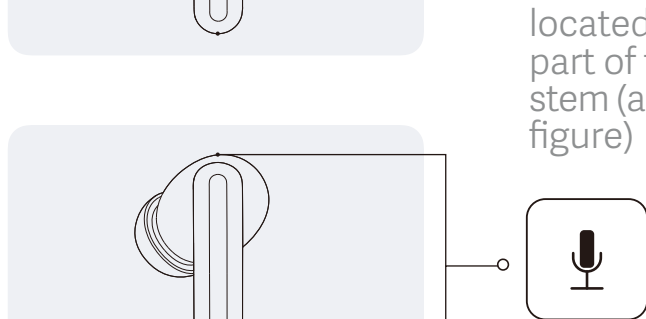
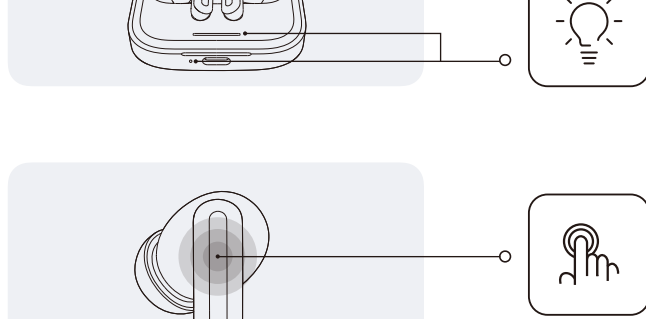
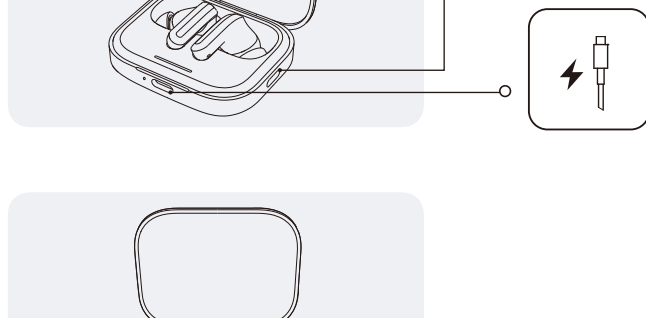

The touch area is located on the upper part of the earbud stem (as shown in the figure)



Package contents

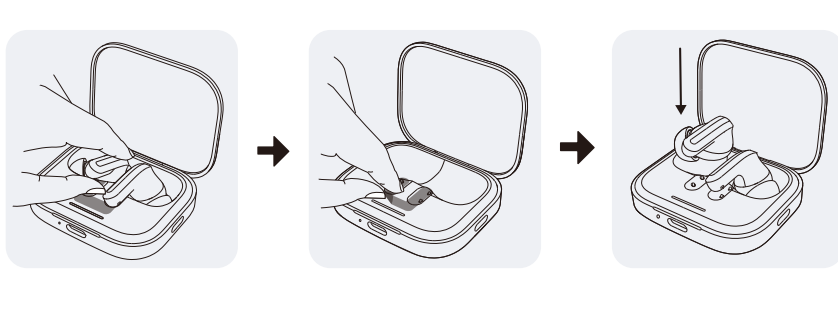
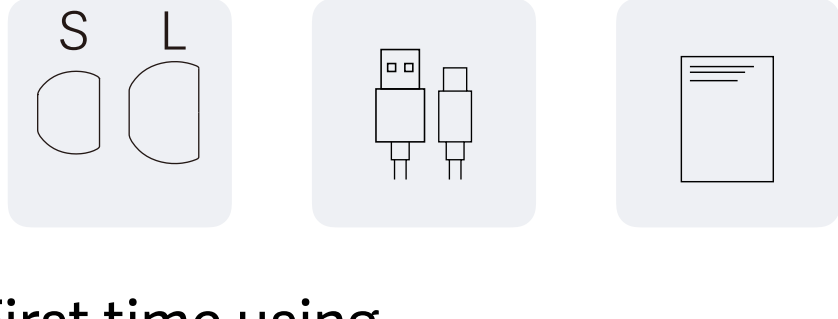

First time using

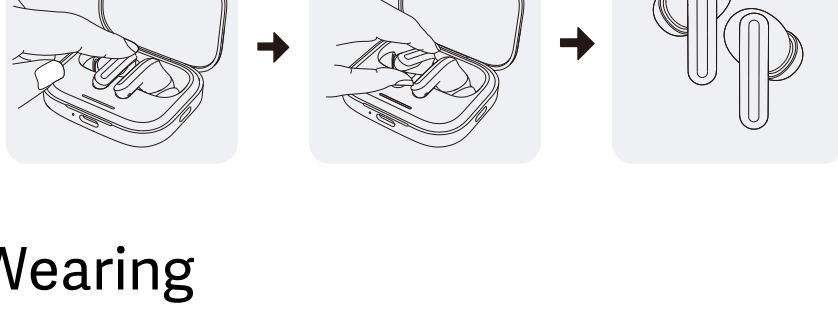

Take out earbuds

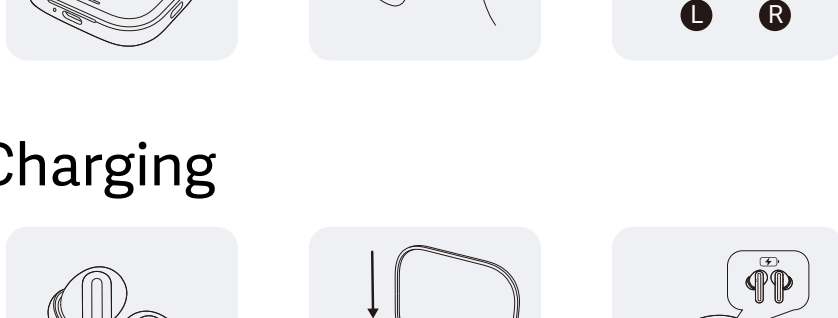

Wearing

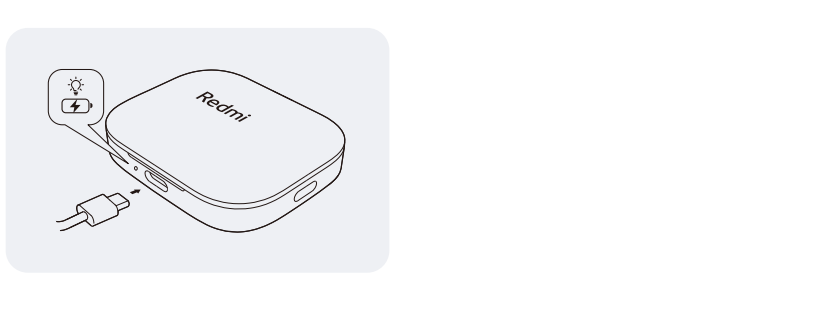

Charging

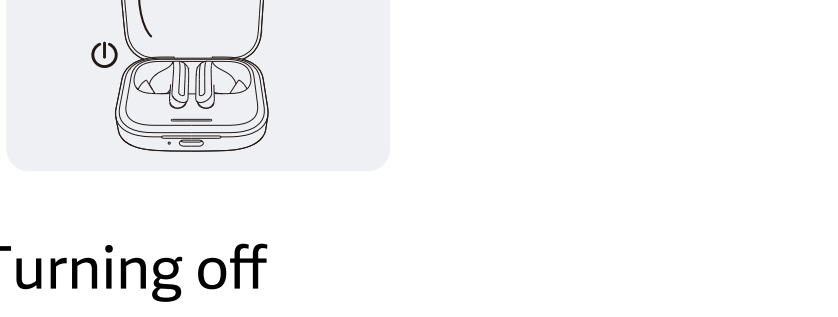

Turning on

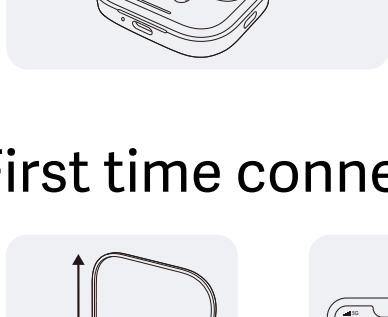

Turning off

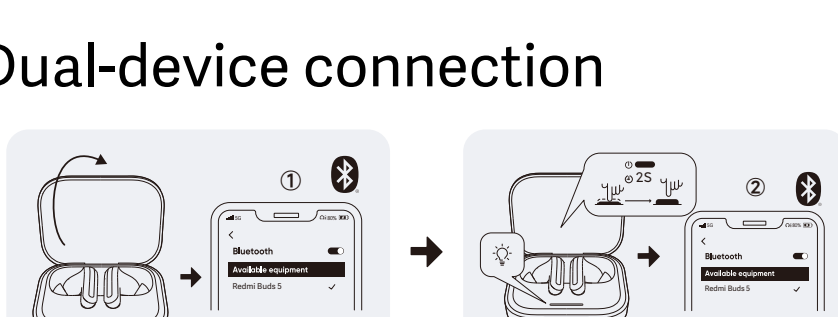

First time connection

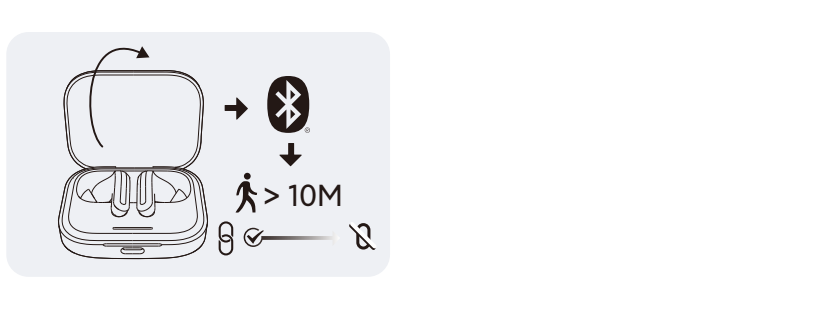

Dual-device connection

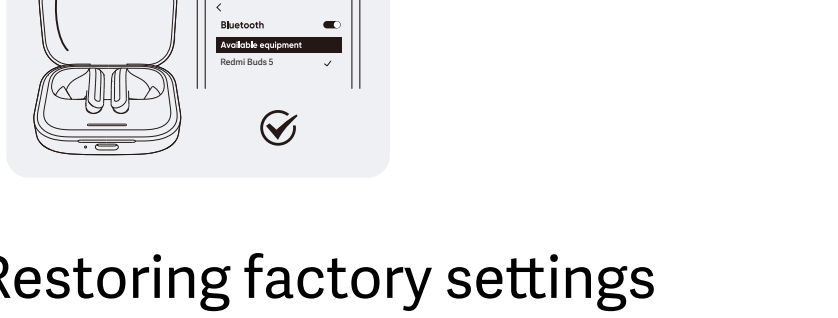

Disconnected

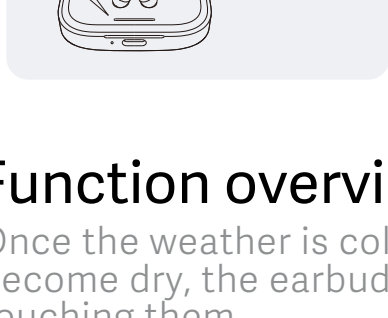

Automatic connection

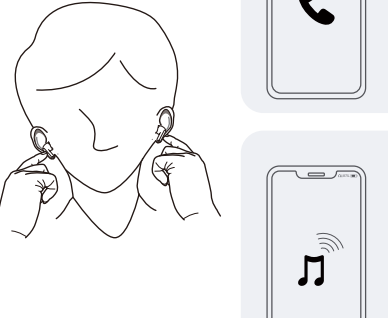

Restoring factory settings



Function overview

Once the weather is cold outdoors and your hands become dry, the earbuds may not function when touching them.



Uygulama ile Bağlanma

1. Daha fazla özellik etkinleştirmek için Xiaomi Kulaklıkları indirmek ve yüklerken QR kodunu tarayın.
2. Kulaklıkları bağlamak için uygulamadaki talimatları izleyin.

(Android & iOS)

Xiaomi Earbuds uygulamasını indirmek için QR kodunu tarayın.

Not:
Bağlantı işlemi sırasında lütfen akıllı telefonun Bluetooth özelliğinin etkinleştirildiğinden emin olun. Kulaklıkları şarj kutusuna koyun, kapağı açın ve akıllı telefonunuzun kutunun yakınında olduğundan emin olun.